

twentyfive7

GAMUDA KEMUNING

QUAYSIDE PLAZAS

SHOP OFFICES



Artist's impression

HOT DEMAND, LIMITED UNITS

From RM9XXK onwards

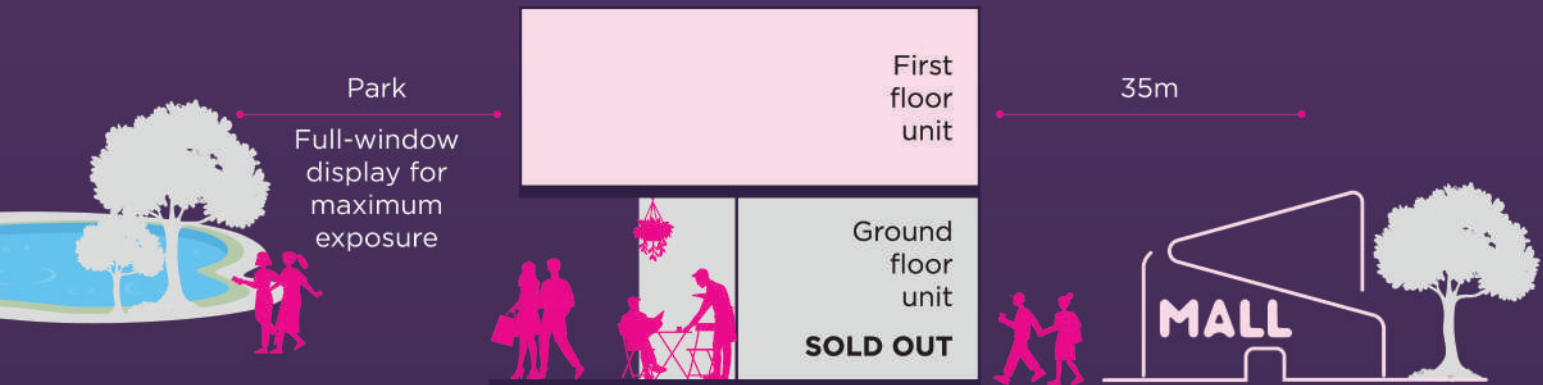

Visible frontage to main road & lush streetscape

725,000 population catchment within 20-minute drive

Walking distance to Quayside Mall



“Capture the **pulse of active community footfall!**”



Situated right next to Quayside Mall

Actual photo

PREMIER LAKEFRONT COMMERCIAL HUB WITH A READY COMMUNITY

This hub is the go-to destination for businesses looking to thrive in a prime lakeside setting.



Business spaces for all occasions

SPACIOUS DESIGN FOR ULTIMATE FLEXIBILITY

“Establish your brand in
the *heart of a vibrant
community!*”



Lakeview cafés & restaurants



Flexible spaces for multi-functional offices

Woven with more than just the
ESSENTIALS
for a thriving township

Site Plan - Level 1

GREEN VIEW

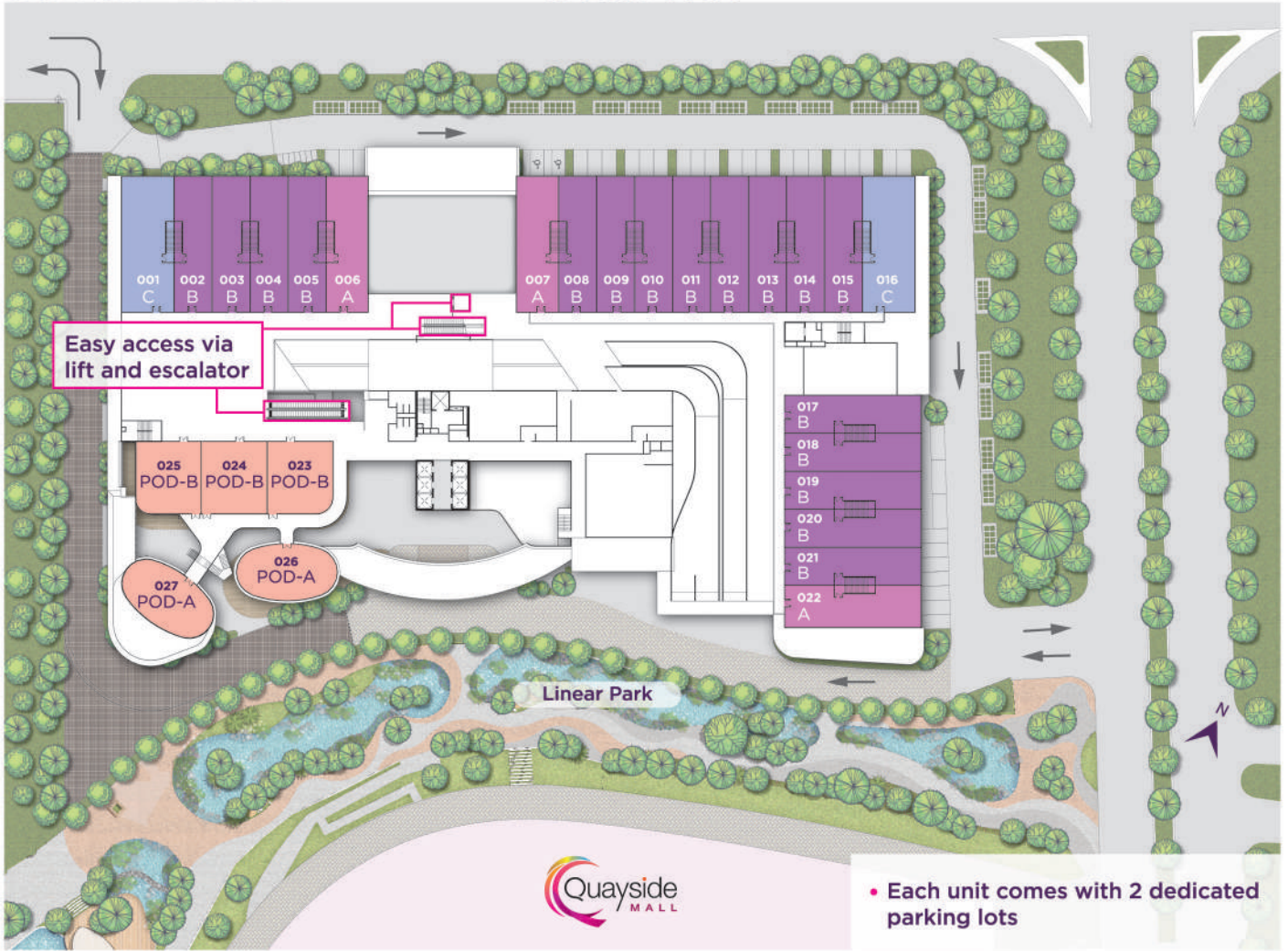

CENTRAL PARK & LAKE VIEW

Floor Plan

TYPE B
INTERMEDIATE

First Floor:
Lot Size: 22' x 77'

2 Toilets Per Floor

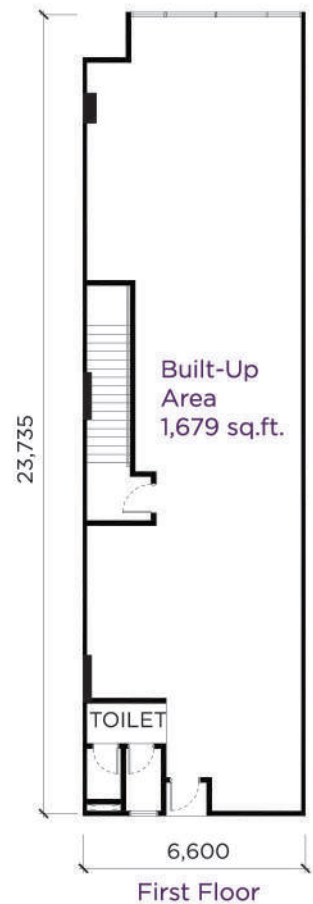

**GROUND FLOOR
SOLD OUT** Own it before it's gone!

CONNECTED CONVENIENCE

ACCESSIBILITY

twentyfive7 is conveniently accessible through five major highways:

- Shah Alam Expressway (KESAS)
- North-South Expressway Central Link (ELITE)
- South Klang Valley Expressway (SKVE)
- Kemuning-Shah Alam Highway (LKSA)
- West Coast Expressway (WCE) - Upcoming Highway

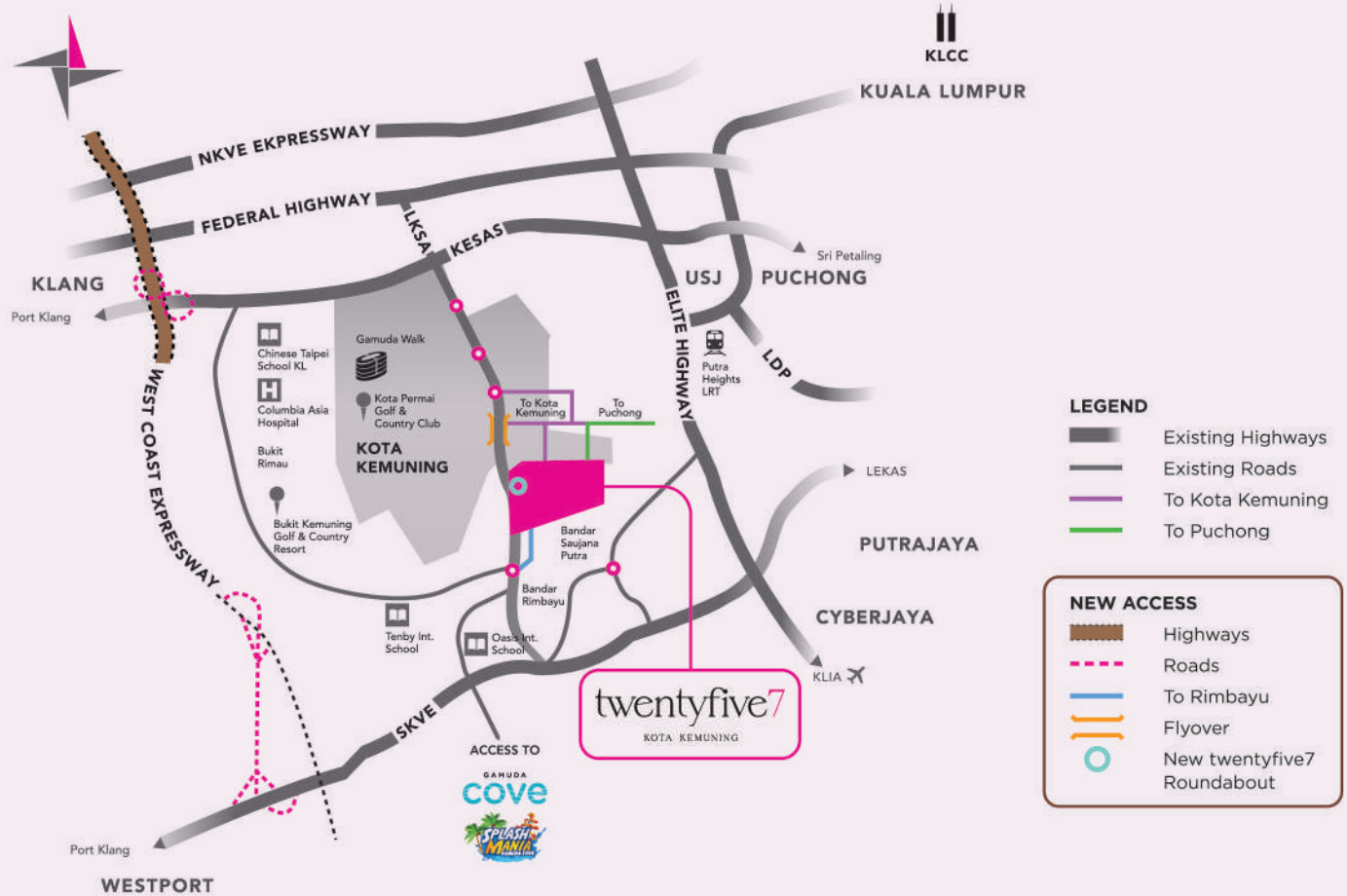

RADIUS	AMENITIES	RECREATION	EDUCATION
WITHIN 3KM	<ul style="list-style-type: none"> • Quayside Mall at twentyfive7 • Jaya Grocer at twentyfive7 • 99 Speedmart at twentyfive7 • TMG Mart at twentyfive7 • MAHSA Specialist Hospital • Anytime Fitness at twentyfive7 	<ul style="list-style-type: none"> • MBO Cinemas at twentyfive7 • Canal Park at twentyfive7 • Central Park at twentyfive7 • Monet's Park at twentyfive7 • Community Park at twentyfive7 	<ul style="list-style-type: none"> • Melody Kindyland at twentyfive7 • Tenby International School • Oasis International School • MAHSA University • The Good International School
5KM	<ul style="list-style-type: none"> • Columbia Asia Hospital • Celebrity Fitness • Gamuda Walk • AEON BiG • Hero Market 	<ul style="list-style-type: none"> • Kota Permai Golf & Country Club • Bukit Kemuning Golf & Country Resort 	<ul style="list-style-type: none"> • SJK (C) Chung Hua Kota Kemuning • SJK (C) Bukit Fraser • SMK Kota Kemuning • SK Bukit Kemuning 2 • Chinese Taipei School Kuala Lumpur
7KM	<ul style="list-style-type: none"> • RHB Bank • Hong Leong Bank • OCBC Al-Amin Bank • Affin Bank • CIMB Bank • Maybank • Putra Heights LRT Station 	<ul style="list-style-type: none"> • Kota Kemuning Lakeside Park 	<ul style="list-style-type: none"> • SK Kota Kemuning • SK Bukit Rimau
10KM	<ul style="list-style-type: none"> • Sentosa Specialist Hospital 		

SincereTM
Responsible
Original

Gamuda Land (Kemuning) Sdn Bhd
(200201030459 (588122-P))
 twentyfive7 Experience Gallery
 Lot 43495, Persiaran Oleander,
 42500 Telok Panglima Garang, Selangor



**FIABCI WORLD PRIX
D'EXCELLENCE AWARDS**
INNOVATION & SUSTAINABILITY



gamudaland.com.my
03 2787 7949

All information contained here (including figures, specifications, plan measurements, and illustrations) are subject to amendments, variations and modifications without notification as may be required by the relevant authorities or developer's consultants, and is not intended to form and cannot form part of an offer or contract. All images, pictures, plans and illustrations are artist's impressions only and may be subjected to changes. Whilst every reasonable care has been taken in preparing this information, the developer cannot be held liable for any variation or inaccuracy.